

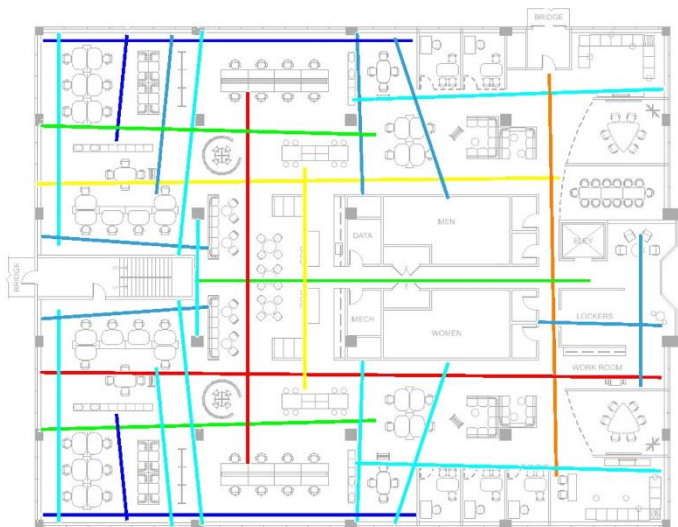

Space Syntax

Margaret Gilchrist Serrato, PhD MBA AIA ASID LEED ^{AP}

Space Syntax is a tool that predicts where movement will occur in a space based on the layout of paths and the number of connections paths have to each other. Integrated paths (red – orange – yellow) have many connections to other paths, while segregated paths (aqua - navy blue) have fewer connections to other paths. Research using Space Syntax has found that in spaces where people are free to move around, most movement will occur on the integrated paths. Movement is important because it is related to frequency and location of informal interactions, which in turn is related to outcomes of performance and innovation. Other design elements that affect the frequency and location of informal interactions are the average distance between people and the degree of visibility into occupied spaces.



Space Syntax diagrams are created by drawing lines that represent all the paths in a space where movement is not restricted by rules or physical barriers. A software program converts the lines into integration values, which are also represented by color. The program also calculates the average number of connections paths have to other paths. This method allows us to predict how well different layouts will support work activities and then align settings with natural patterns of movement and encounter. For example, areas for individual or

head's down work should be located on or near blue and aqua paths, while more collaborative, social areas benefit from being located on or near orange and red paths.

For more information, please contact margaret@arealogic.com.